

iLOFT CITY VIDEO KIT MANUAL

CONGRATULATIONS ON PURCHASING THIS QUALITY PRODUCT!

Fermax electronics manufactures and develops top class equipment which fulfil the highest design and technology standards.

The iLoft Video Kit includes the iLoft, hands free, video door entry monitor. The full colour screen allows you to communicate with the entry panel, see the caller and open the entrance door if you wish.

We hope you enjoy its range of functions.
www.fermax.com

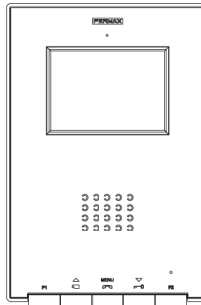

iLoft Monitor

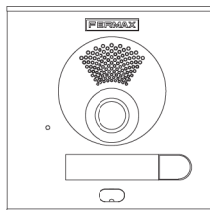

City Entry Panel

This technical document of an informative nature is published by FERMAX ELECTRONICA S.A.E., which reserves the right to modify characteristics of the products referred to herein at any time and without prior notice. These changes will be reflected in subsequent editions of this document.

TABLE OF CONTENTS

SECTION I - INSTALLATION MANUAL	7
<i>Installation</i>	
Power Supply	8
Entry Panel	8
Monitor	9
<i>Equipment Descriptions and Settings</i>	
Entry Panel	10
iLoft Monitor	11
<i>Technical Features of the Equipment</i>	12
<i>Wiring Diagram</i>	13
<i>Extensions</i>	14
<i>Equipment Programming:</i>	
iLoft Monitor. ADS Programming	15
SECTION II - USER MANUAL	17
<i>iLoft Monitor</i>	18
Controls	18
Operation	19
Monitor Settings	20

Section I - Installer Manual

POWER SUPPLY INSTALLATION

DIN rail Installation

Fixing with screws

Assembly

Disassembly

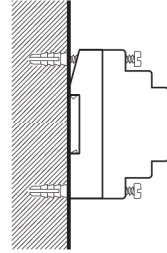
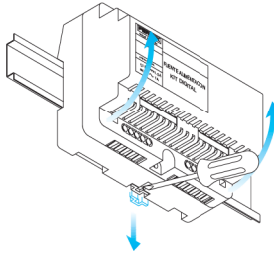
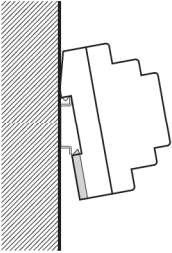

OUTDOOR PANEL INSTALLATION

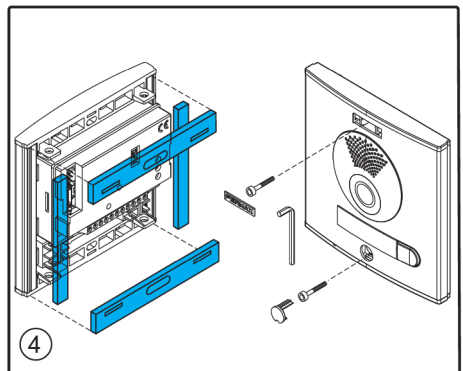
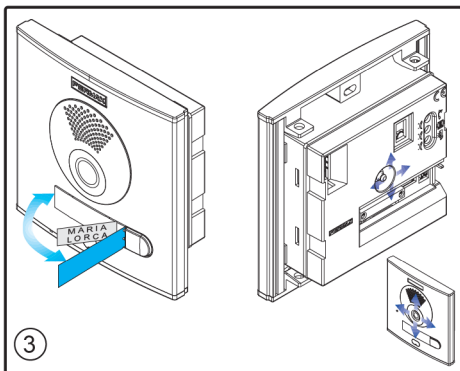
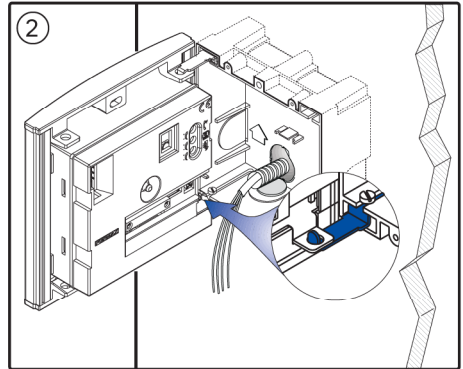
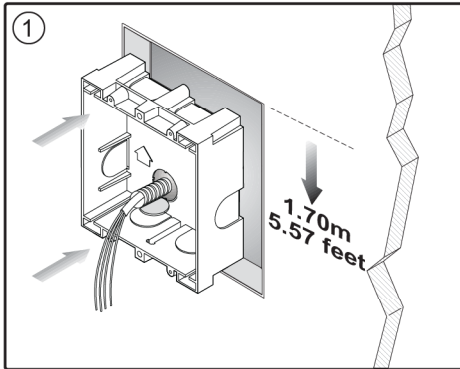

MONITOR INSTALLATION

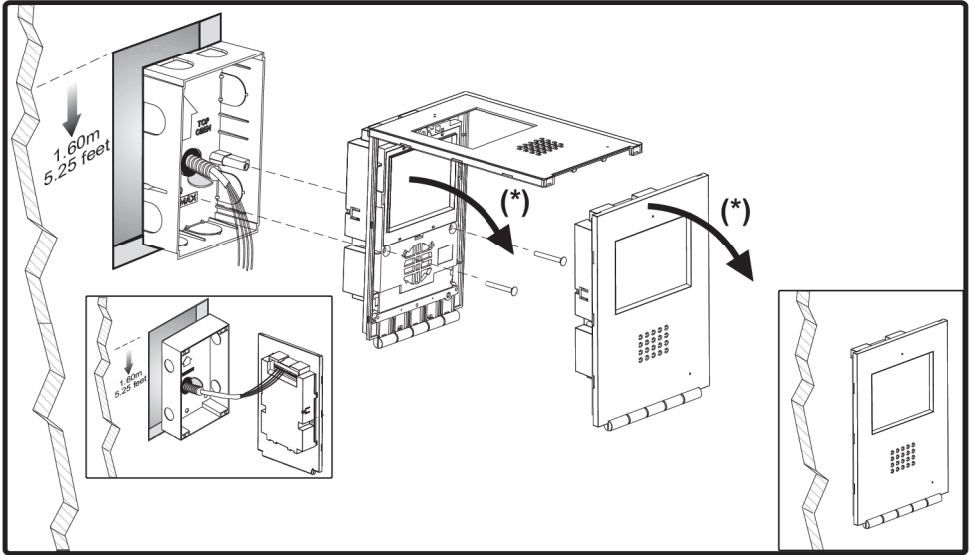

(*) Remove electrostatic protective tag.

Dimensions of monitor (Height x Width x Depth.): : 197 x 131 x 60 mm / 7,7" x 5,1" x 2,3"

Dimensions of Fermax box (Height x Width x Depth): 158 x 108 x 45 mm / 6,2" x 4,2" x 1,7"

DESCRIPTION OF EQUIPMENT

Outdoor panel

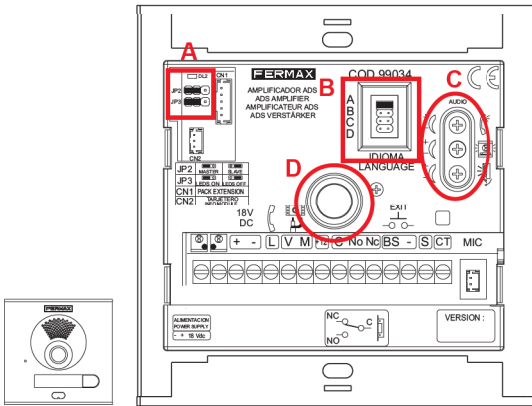

Panel Connectors:

- Video terminals (coaxial):
 - V: live
 - M: shield
 - Ct: camera activation (10 Vdc)
- System connection terminals:
 - +, -: power supply (18 Vdc).
 - +12: 12 Vdc output.
 - L: data bus.
 - C, NA, NC: relay contacts (door-opener connection)
 - BS, -: entrance hall button.
 - SP, - : door-open sensor.
 - S: activation of the exchanger
 - : Button Connection (prewired in factory).

A) Configuration Switches:

JP2 : Main Panel/Secondary Panel Selection. <i>Default Configuration: Main Panel</i>	Main Panel	Secondary Panel
JP3 : Led Camera Lighting	Leds ON	Leds OFF

B) Voice Synthesizer:

Select language for «open door» message.

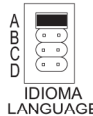

- A: Español
- B: Français
- C: English
- D: Deutsch

C) Audio Settings:

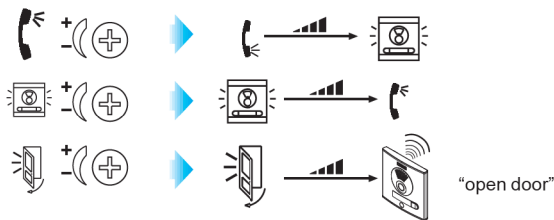

D) Focus the camera:

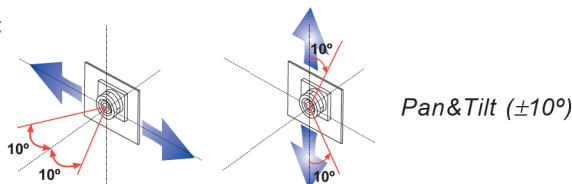

iLoft Monitor

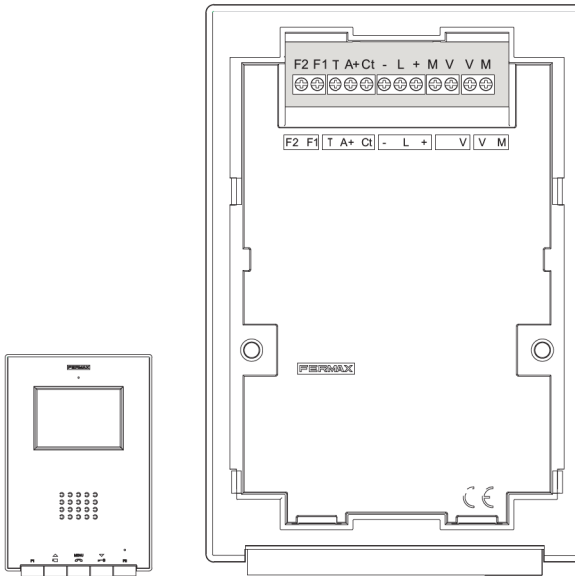

Monitor Conectors:

- Video terminals (coaxial):
 - V:** live
 - M:** shield
 - Ct:** camera activation (10 Vdc)
- Connection Terminals:
 - +, -:** 18 Vdc power supply).
 - L:** data bus.
 - F1, F2:** additional functions (negative output «-»).
 - T, -:** Call Button Connection for Door of Residence
 - A, +:** Call extension connection ref. 2040, light and bell activator ref. 2438, etc...

Programming display: shows the ADS call number programmed.

PRG button: button to go into programming mode.

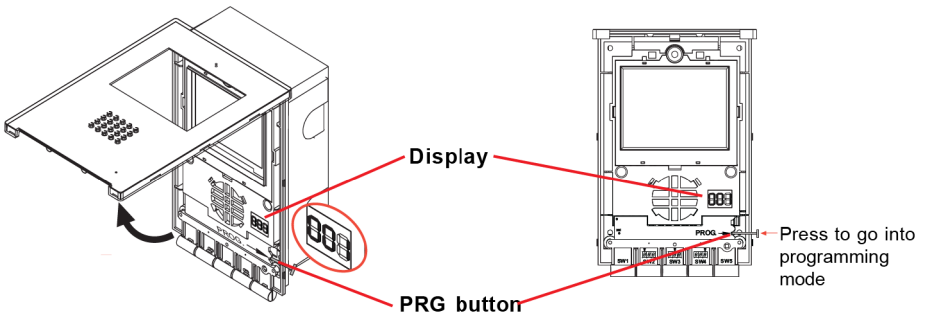

TECHNICAL FEATURES

 <p>IP43</p>	Power Supply	18 Vdc
	Consumption	
	on standby	57 mA
	with video	180 mA
	with audio and video	390 mA
Operating temperature		[-10 , +60 °C] [14, 140°F]
Audio power from the apartment to the panel		1 W
Audio power from the panel to the apartment		0,15 W
Adjustable volume both ways		

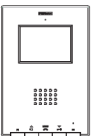
	Power Supply	18 Vdc
	Consumption	
	on standby	15 mA
	making a call	300 mA
	with video	250 mA
	with audio and video	400 mA
Operating temperature		[5 , +40 °C] [41, +104 °F]
Humidity		[0 - 90%]
TFT Flat Screen. 4" Diagonal - Resolution: Horizontal: 480 Line TV - Vertical: 234 Line TV		
Video signal: Compound signal 1 Vpp 75 Ω, 7 Mhz		
Dimensions of monitor (Height x Width x Depth):		197 x 131 x 60 mm / 7,7" x 5,1" x 2,3"

WIRING DIAGRAM

(* IMPORTANT

Set up a 10Kohms resistance between the + and L terminals on the last monitor.

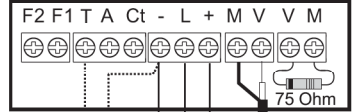
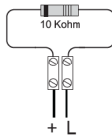

P1

P1: Call pushbutton at the apartment's door.

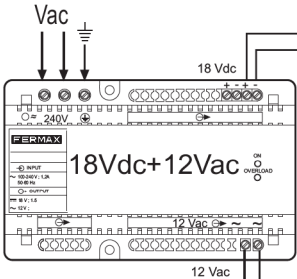
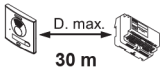

COAX

metros / metres	pies / feet	mm ²	AWG	
1 - 50	3 - 150	1 mm ²	17	75 Ohm
50 - 100	150 - 300	1,5 mm ²	15	75 Ohm
100 - 200	300 - 600	2,5 mm ²	13	75 Ohm

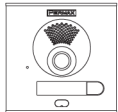
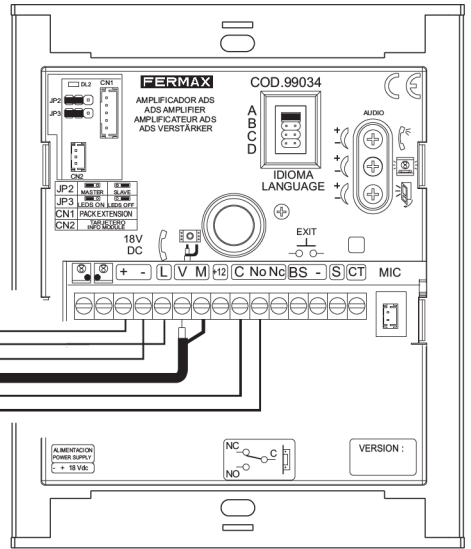

ALIMENTACION
POWER SUPPLY
+ 18 Vdc



VERSION :

EXTENSIONS

This Kit can be extended with two telephones or an additional monitor without the need for extra power supplies.

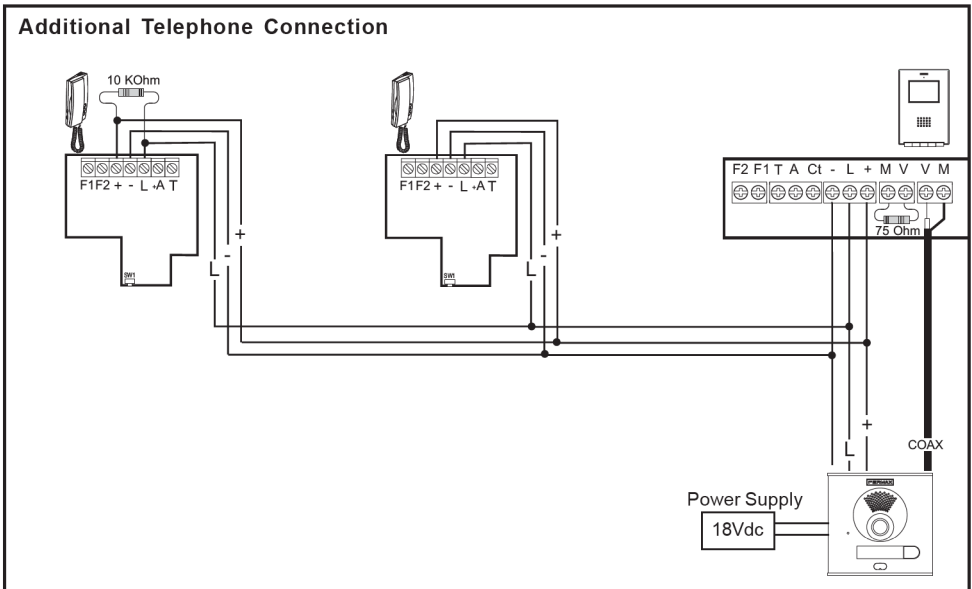
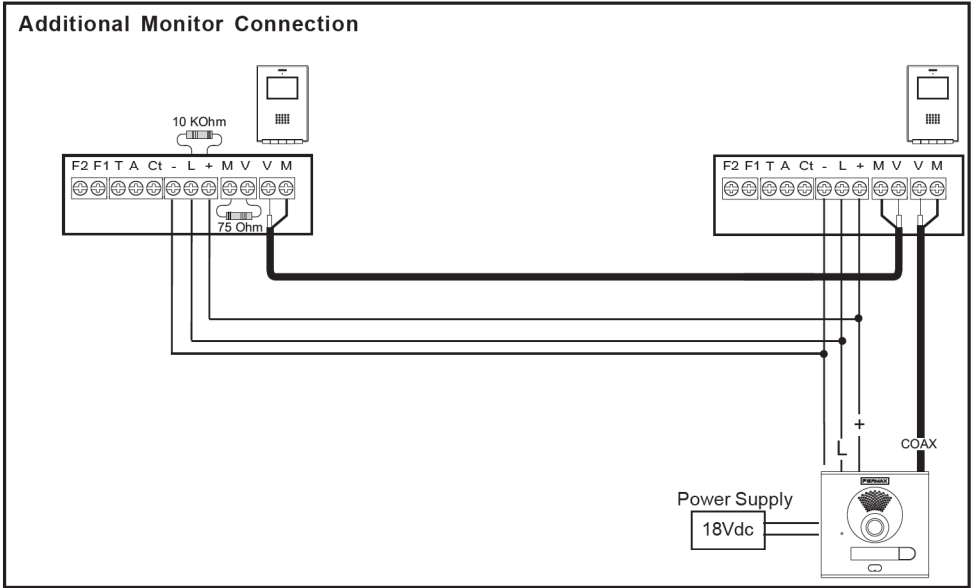

PROGRAMMING THE iLOFT MONITOR

Option 1: From Panel + Monitor

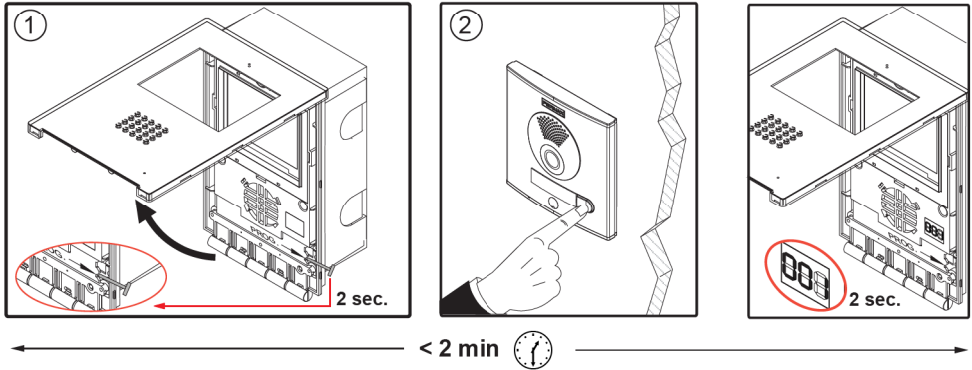

Option 2: From the Monitor

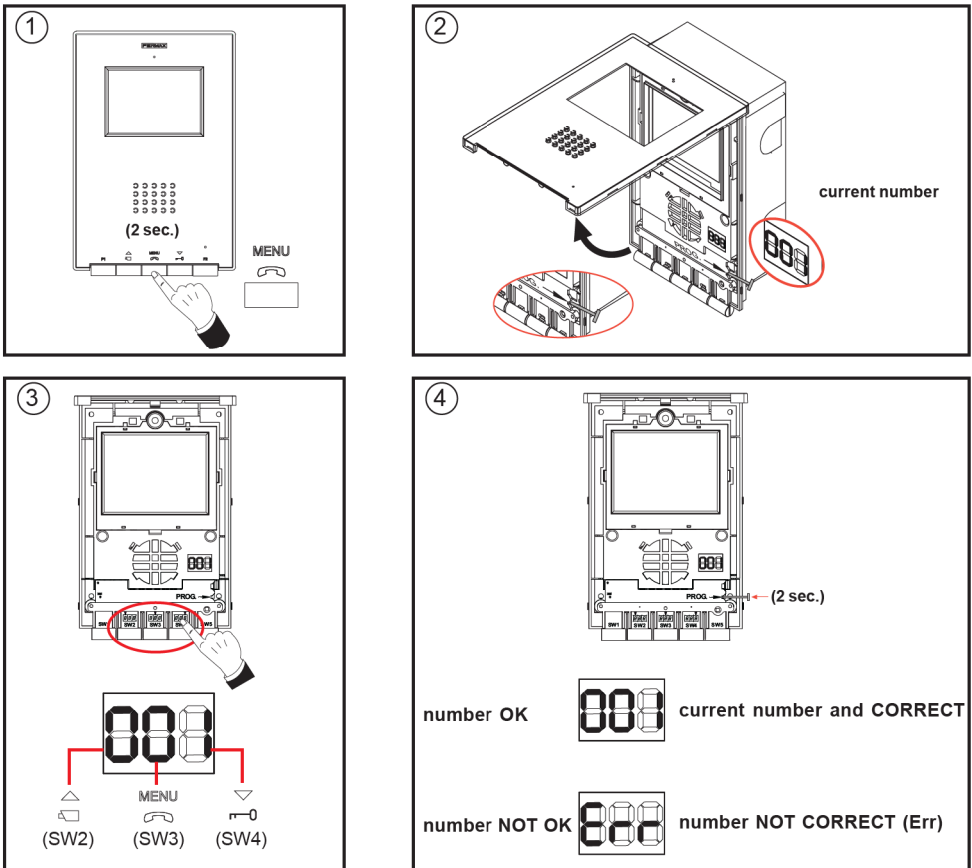



The monitor will not function until it has been programmed!

Option 1: From Panel + Monitor

1. With the monitor connected, press the programming button «PROG →» for 2 seconds (to access this, you must lift up the front cover). A confirmation tone will be emitted.
2. Press the call-to-residence button. A different confirmation tone will once again sound, and the programmed number will be shown on the DISPLAY (for 2 seconds).

Option 2: From the Monitor

1. *Go into configuration mode:* Press the button  for two seconds. The LED blinks once each second and a confirmation tone is emitted.
2. *Put the monitor into programming mode:* With the monitor connected, press the programming button «PROG →» for 1 second (to access this, you must lift up the front cover). A confirmation tone will be emitted.
The first thing the monitor then does is indicate the number of the current monitor on the DISPLAY. If it is not programmed, it will show the following: - - -
3. *Programme the call number:* Each time the button corresponding to hundredths, tenths or units is pressed, the figure goes up by one and is shown on the DISPLAY.

Hundredths: Press the button  (SW2)

Tenths: Press the button  (SW3) →

Units: Press the button  (SW4)

Once you reach 9, if you press again, it returns to 0 and a low error tone is emitted. The next time you press, it will go to 1.

4. *Exit programming mode:* Press the programming button « PROG →» for 2 seconds, or wait 30 seconds before pressing any button.

When you exit programming mode, the number indicated is stored. If it is correct (between 1 and 199), a confirmation tone is emitted; if it is not correct, an error tone is emitted, and the «Err» message is shown on the DISPLAY.

Section II - User Manual

Congratulations on purchasing this quality product!

The iLoft Video Door Entry System includes the iLoft Monitor. The full colour screen allows you to communicate with the entry panel, see the caller and open the entrance door if you wish.

We hope you enjoy its range of functions.
www.fermax.com

ADS iLOFT MONITOR

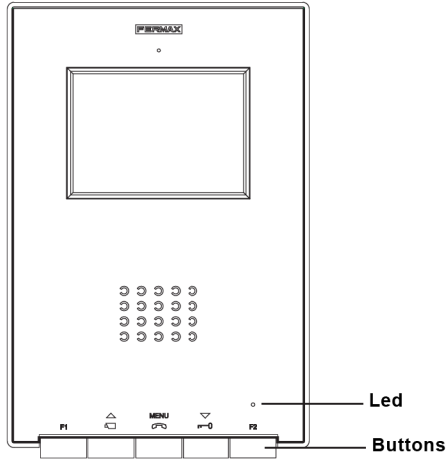

Buttons



Audio Activation, Hanging-up and Configuration-adjustment Button (menu).

- When a call is received, press this button to speak to the visitor. The audio channel between the street and the home is opened; operation is in hands-free mode.
- Press to end the communication.
- With the monitor on standby, press this button for 2 second to go into monitor configuration mode. See the «Monitor Settings» section.



Door-opener / call to reception button.

- When you are in conversation with the Street Panel, pressing this button will activate the *door-opener*.
- With the monitor on standby, when you press this button a *call will be made to reception* (if there is one).



Auto-start / Main-Secondary Camera Selection Button.

- With the monitor on standby, press this button for 1 second to switch the monitor on manually. To activate the audio, press the button .
- With video, hold this button down for 2 seconds to sequentially select between the main camera and the secondary camera (if there is one).



F1 and F2: Buttons for Additional Functions (assigned by the installer).

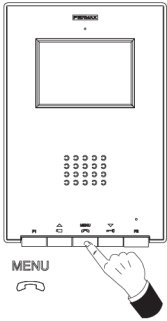

NOTE: The monitor screen goes on once the call from the panel has ended.

Operation



Answering a call

When the call button on the **Street Panel** is pressed a call tone is emitted both at the panel and on the monitor, and the screen goes on.

Press the button ^{MENU}  to speak with the visitor. The audio channel between the street and the home will be opened; **operation is in hands-free mode**. The communication will automatically end after 90 seconds, or at any time by pressing the button ^{MENU} .

If communication is not established with the street panel, the monitor will automatically go off after 30 seconds.

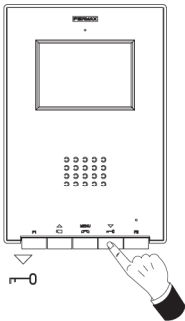

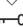

Opening the door

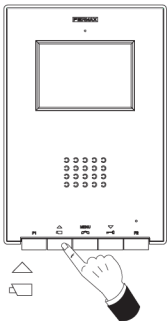
When a call is received from the street panel, it is possible to open the door at any time, by pressing the button  .



Manual Activation of the Monitor (Auto-start)

With the monitor on standby, press this button  for 1 second to switch the monitor on manually. To sequentially select between the main camera and the secondary camera (if there is one), hold the button  for 2 seconds.

To activate the audio and speak to the visitor or open the door, carry out the steps described above.

If communication is not established with the street panel, the monitor will automatically go off after 30 seconds.

NOTE: If there is more than one iLoft monitor in the system and a call is made to a monitor, the rest of the monitors will show a blue led warning that the channel is busy.

Monitor settings

To access **configuration mode**, press the button  down for two seconds (*the led will blink once a second and a confirmation tone will be emitted*).

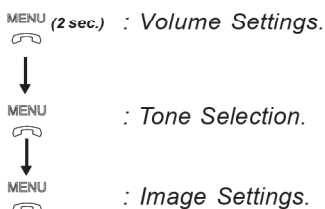

On accessing configuration mode, the monitor will go into **volume settings mode**.

Press the button  to move through the configuration options in order:



To adjust the different configuration options, while in the required option, follow these steps:

Set Call Bell Volume

- press the button  to select a *high volume* or
- press the button  to select a *low volume*.

Call Tone and Call Cancellation (do not disturb mode)

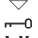
- press the button  to select the call tone. You will go through all the brightness-contrast configurations it incorporates.
- press the button  to activate the call cancellation function (do not disturb mode);
The monitor led blinks on red to indicate «do not disturb» mode

To reactivate call functions, press the button .



Image Settings (Brightness-Contrast and Colour)

In *image configuration mode*, the led blinks once every two seconds, indicating that the monitor is in this mode.

The monitor has 4 pre-established settings with a specific level of brightness and contrast and 4 colour levels.

On pressing the corresponding button you can select the brightness/contrast level or colour setting.

When you come to the last option, an error tone is emitted and it returns to the first one.

- press the button  to select brightness and contrast.
- press the button  to configure colour.

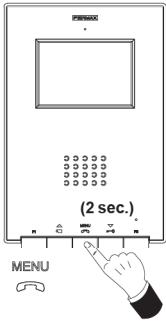

iLoft Monitor Settings - Quick Guide

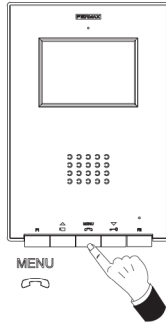

Go into configuration mode

Call Volume Settings



-  **HIGH Volume**
-  **LOW Volume**

Melody Selection and call cancellation

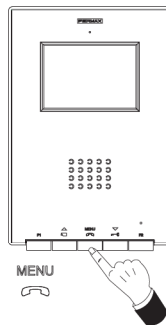



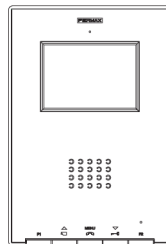
-  **CALL TONE Selection**
-  **CALL CANCELAN**

Image Configuration



-  **BRIGHTNESS-CONTRAST**
-  **COLOUR**